

## AUTOMATIC REMOUNTED SYSTEM FOR HALF PALLETS



### WORKING

Lifting system of two half pallets (600 x 800 mm) to put on a pallet 800 x 1200 mm.

### TECHNICAL SPECIFICATION

Very robust design. All mechanical, pneumatic, electrical and electronic are high quality, standards and available on the market.

### OPTIONS AVAILABLE

Automatisation with automatic wrapping machine for half pallets individually and subsequently grouped to film two half pallets on a 800 x 1200 mm.mm.

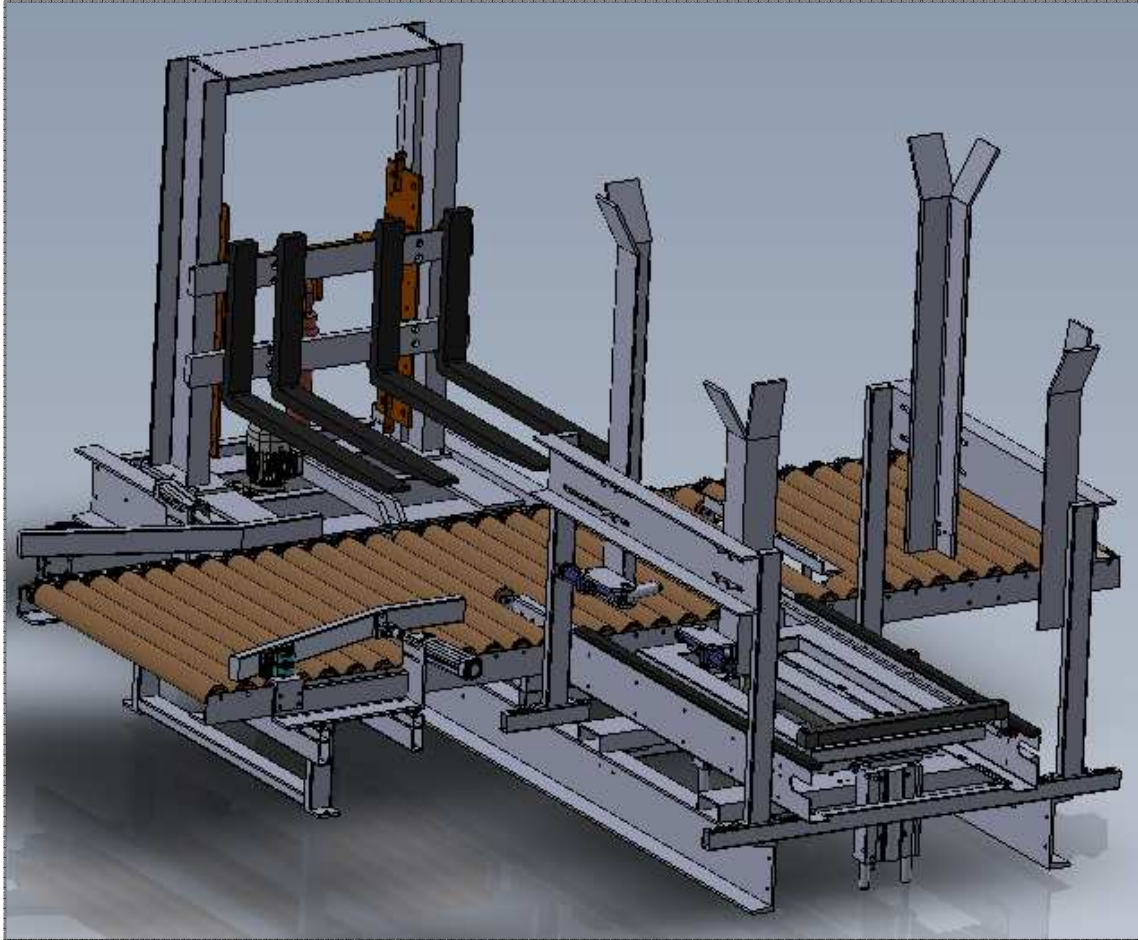

Voltage	220 V ou 380 V
Installed electric power	2 KW
Air pressure	6 atm.

